



A SUMIT KALYANMAL MANTRI ENTERPRISE  
**SHUBHAM  
VALLEY**



Developer & Colonizer  
**SHUBHAM GROUP**  
Office : 304 Zodiac, Scheme No.140, Indore. 9669157000



Promoted & Marketed by  
**413 Apollo Premier, Vijay Nagar Square**  
**MR-10 AB Road, Indore**  
Rera No - A-IND-24-1824

**Call: 8982888772, 8982185557**

Follow Us : Shubhamgroupindore   [www.shubhamgroupindore.com](http://www.shubhamgroupindore.com)

RERA : P-IND-22-3464 dated 16.06.2022 | Development Permission : अ. क्र. 0014 / अ-74 / 2022-2023 dated 08.04.2022

TNCP : INDLP-6214 dated 10.02.2020 | Diversion Order : अ. क्र. 44 / अ-2 / 2020-2021 Dated 18.12.2020

Coloniser Registration Number : 104/2021 | Coloniser Licence : अ. क्र. 48 / अ-74 / 2020-2021 dated 27.10.2021

Disclaimer : The brochure is only for illustration and private circulation purpose and is not a legal document or a binding one. Commencement and timely execution of project is subject to all necessary approvals from government on time, occurrence of any natural or man made calamities that are beyond the control of the developer. The dimensions shown in the brochure are indicative. Please note that developer/architect constantly seek ways to improvise the offerings and hence any alterations in the scheme as a whole or part may take place at the sole discretion of the developer. No information given in this brochure creates a warranty or expands the scope of any warranty that cannot be disclaimed under applicable law. Your use of the brochure is solely at your own risk. You are therefore requested to directly verify all details and aspects of any proposed booking/acquisition of units/premises, directly with our authorised sales team. Though best efforts are made to produce up-to-date literature this brochure should not be regarded as an infallible guide to current specification nor does it constitute an offer for sale of any particular unit. Subject to Indore jurisdiction.



A SUMIT KALYANMAL MANTRI ENTERPRISE  
**SHUBHAM  
VALLEY**

**WAKE-UP TO A  
CAPTIVATING VIEW,  
EVERYDAY!**





# A SERENE VIEW

Shubham Group presents its latest - premium, yet affordable project "Shubham Valley" which is located at bypass road, adjacent to DPS School, Rau. The project is situated at the most iconic location, on a hill top in the vicinity of mountains providing the most exotic and panoramic view of the city for the customers. It's unique and attractive and at the same time very rare for a city like Indore. It full-fills it's customers aspirational value and provides unmatched locational advantage. It provides high level of living ecosystem in its radius of 5 kilometer where-in approximately 2 lac population is already residing. All kinds of facilities are available within 5 to 10 minutes distance. If we talk about schools - DPS, one of the most prominent schools just adjoins to this project and Sage University is nearby. For entertainment, Windasa open theatre and Amusement park adjoins the project from the other side. Hospitals and many other institutions are not far away either. MR-3 road connectivity is an added value for the project and Rau circle is just 3 minutes drive away. Shubham Valley is a one of it's kind project that depicts the expression of peaceful living within the city within the budget of the customers. Keep flying high and live with privilege with Shubham Group at Shubham Valley!



A SUMIT KALYANMAL MANTRI ENTERPRISE

**SHUBHAM  
VALLEY**





# A COMFORTING VIEW

Leave the bustle of everyday city life behind and wake-up to a truly mesmerizing view of the Ahilya Hills. Step in to the lap of luxury at Shubham Valley A community that has been thoughtfully designed keeping the goodness of nature intact. It's time to lose yourself in nature's beauty.





# A GRAND ENTRANCE

You have long cherished a beautiful dream of your home amidst the beauty and serenity of nature. Your every thought will come to life as you enter the premises of this mesmerizing township, Shubham Valley.





# THE AMENITIES

Life is wonderful when you get the comforts without worries.  
Here you'll get them all.



Integrated shopping complex & office space



Fully covered (boundary) & guarded campus



Private temple for residents



Main Road facing commercial plots



32 feet wide main road & 30 feet wide roads



Front boundary wall for every plot



City Bus facility in vicinity



Fully underground Drainage, Storm water & Water-supply system



Open Air Gym



Nature Walk



Easy Finance

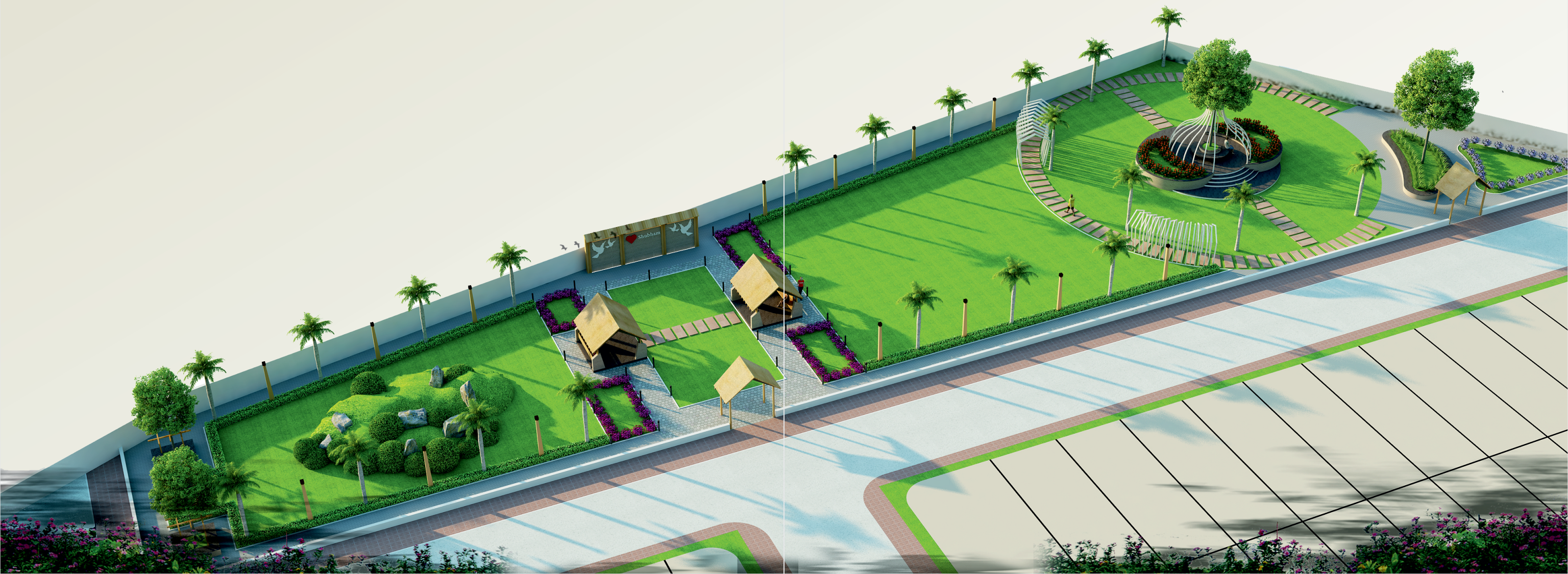





# THE MASTER PLAN



Plots are available in various configurations as listed below, ranging from 600 to 1200 square feet

20 x 60 = 1200 sqft  
17 x 50 = 850 sqft  
15 x 45 = 675 sqft  
15 x 40 = 600 sqft



**ABOUT SHUBHAM GROUP**  
BUILDING DREAMS WITH COMMITMENT SHUBHAM GROUP has been one of the most premium and trusted real estate developer in central India with more than 20 years of experience in this business. Since its inception in 2001 trust of the people in Shubham Group has been the foundation for our success. And their unwavering faith motivates us to serve even more. Thousands of the families who have created a future with us, will testify for the value that we have added in their lives.

Founded in 2001 the Brand SHUBHAM GROUP has come a long way under the vision of **SUMIT MANTRI** (Managing Director) construction and contracting business was our initial area of focus. Eventually the company diversified into real estate sector. In the last 20 years Shubham Group has stayed true to its motto '**Building dreams with commitment**' guided by its founding values of delivering quality and excellent real estate spaces. We acknowledge the possibilities that the technology offer, that's why we incorporate technological innovation in our real estate projects and give people excellence and precision in everything. Ultimately providing an amazing experience to the people is our endeavour.

Shubham Group has delivered some land mark projects and engineering marvels, thereby creating a niche for itself in both luxury and affordable segments. ShubhamGroup strives to achieve customer satisfaction. While redefining people's lifestyle and giving them their happy space. We have carried back millions of precious smiles along the way. Apart from corporate excellence we also understand our social commitments. We have taken up many CSR projects in the field of health, education, community development and more. So far the journey has been incredible but there are still more chapter to be added to this story.

